



## Personal mobile phone policy at EEB1

*“At school we learn to live and work together,  
we learn to forge relationships with one another*

### Preamble

Considering the scientific warnings about the impact of recreational screens on the health, well-being and cognitive capacities, including concentration, of children and pre-adolescents,

Considering the increasing number of measures taken in recent years in several European Union countries and around the world, the management of EEB1 has decided to change its policy on personal mobile phones in our School.

This policy will come into force **on 4 September, 2024**: we appeal to everyone's sense of responsibility to respect and enforce the rules described therein. In particular, we urge students, if they have personal mobile phones or other connected personal electronic devices, **not to bring them to school**.

We are convinced that the positive effects of these new **rules** will include **more social interaction within the school, better concentration of our students in class for a better working atmosphere, more productive teaching and the development of everyone's interpersonal qualities to live and work together while forging better relationships with one another**. This is a real shared responsibility (**School - Parents - Children**), and we are asking each and every member of our large School Community (students, teachers, educational staff, parents, administrative staff, etc.) to **fully commit to it, by setting an example, to ensure its successful implementation**.

This policy will be widely communicated using the means at our disposal (publication on our school website, in-class presentation to all students at the start of the new school year, passing on by parents and regular reminders as needed).

This policy is intended to be a living, evolving document: regular evaluations will be communicated to our Education Councils and Administrative Board.

## Personal mobile phone policy at EEB1

### Rules

- 1) Personal mobile phones\* are not permitted at the European School Brussels-I Uccle-Berkendael. This rule also applies to off-site school activities (trips and excursions, visits).
- 2) However, S6 and S7 students, under very strict conditions, are authorized to use their personal mobile phones\* in certain areas of the School\*\* for academic purposes only (e.g. for educational or career guidance purposes). Consequently, taking photos or videos, playing video games or consulting online social networks outside school purposes are not authorized.
- 3) Controls are in place, as are appropriate sanctions in the event of non-compliance.

\* The objects referred to in this document as "mobile phones" include: simple, non-connected cell phones, smartphones, connected watches, handheld video game consoles, tablets, wireless headphones or headsets, or any other connected or unconnected electronic object.

\*\* Authorized areas for S6 and S7 students only: S4-S7 library (according to library rules), S4-S7 cafeteria and an outdoor area behind the Villa, between the Aristotle building and the sports halls (in red hatching in the image below), subject to modification by decision of the EEB1 School director.

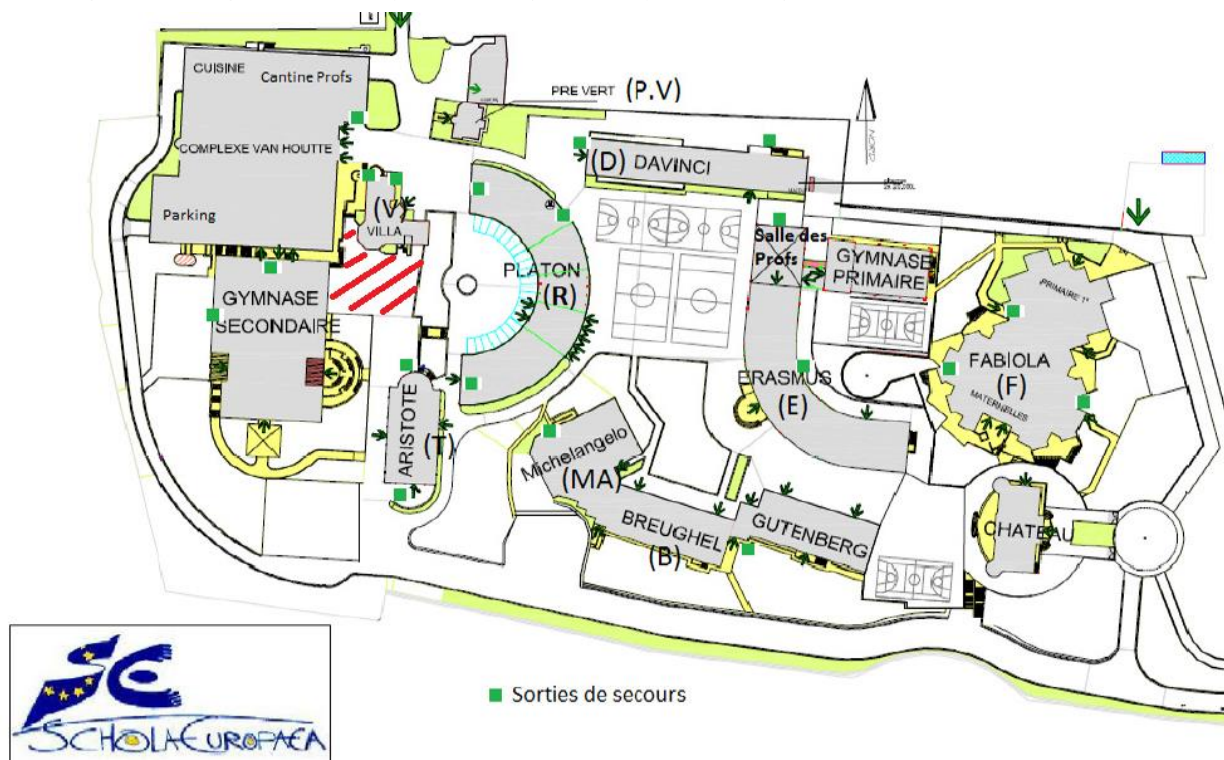

## Personal mobile phone policy at EEB1

### Sanctions

Contravention of the rules	Consequences/Sanctions
First contravention	Parent(s)/Legal guardian(s) and for students in the Secondary cycle: two periods of detention on Wednesday afternoons.
Second contravention	Meeting with parent(s)/legal guardian(s) (online or <i>on site</i> ) and for students in the Secondary cycle: two periods of detention on Wednesday afternoons.
Third contravention	Meeting with parent(s)/legal guardian(s) <i>on site</i> and temporary exclusion*** from classes.
Fourth and subsequent policy contravention	Meeting with parent(s)/legal guardian(s) <i>on site</i> and for students in the Secondary cycle: organisation of a disciplinary council.

\*\*\* The student will be suspended from classes and will have to do some reflection work. He/she will also have to catch up on missed classes.

In the event of non-compliance, the School Management reserves the right to securely and safely disable the personal mobile phone, in accordance with procedures to be specified at a later date for Nursery, Primary or Secondary cycles.

## Personal mobile phone policy at EEB1

### Frequently asked questions

- 1) What is the situation under the rules for children with special needs (e.g. educational or medical) who require a mobile phone?

If the needs are attested (by an agreement with the School for educational needs or by a medical certificate, for example) and the use of a personal mobile phone or other personal electronic device is necessary, an exemption may be granted by the School. Parents/Legal guardians must contact the management of the cycle/campus concerned to request such an exemption.

- 2) What should parents/ legal guardians do if they need to contact their child during the school day and vice versa?

- In the event of an emergency involving a student during the school day, school staff will contact the parents/legal guardians.
- Should the parents/legal guardians need to pass on an urgent message to a student, they can always contact the school counsellors or the Vie Scolaire staff. The school staff will then pass on the urgent message to the student concerned, if they are still on the school premises.
- If a student needs to contact their parents/legal guardians urgently during the school day, they can contact their class teacher in the Nursery and Primary cycles, and in the Secondary cycle, the team of counsellors, as well as any adult who can direct them to the most appropriate service (secretariat, administration, etc.).

In addition, students from S4 to S7 with a green exit card can also leave the EEB1 campus during their lunch break and for S6-S7 during their free periods.

- 3) Are S6 and S7 students authorized to use their personal mobile phones on the school site?

Students in S6 and S7 may only leave and/or use their mobile phones in the areas specifically indicated in this policy. Please note that the provision of Belgian law and the School's rules apply to all members of our school community. In particular, these rules restrict or prohibit the taking of photographs, filming or use of a person's image without the prior consent of the person or the prior consent of their parents/legal guardians, where applicable. From a general point of view, any action aimed at and/or effectively prejudicing the reputation, private life and image of any person, in particular by means of denigrating, offensive or defamatory images or comments, is strictly forbidden. School rules also prohibit playing video games and accessing inappropriate content on school premises and/or during school hours.

- 4) Can personal mobile phones be used in classrooms?

Students are not allowed to use personal mobile phones in classrooms. Teachers may not require the use of personal mobile phones in class.

- 5) Are children allowed to bring a personal mobile phone to school if they are not using it during the school day?

Students up to and including S5 are advised to keep their personal mobile phone at home if they have one.

If a student brings their own mobile phone, we recommend that they switch it off as soon as they enter the site, and place it in a safe place (e.g. their locker).

In all cases, the School cannot be held responsible for any damage, loss or theft of personal equipment brought to school by the student.